

Amphenol LTW

- Power, data / signal, hybrid
- IP68 mated or unmated
- Blind mating with audible feedback
- Compact design
- Flammability UL 94V-0
- UV resistant

HS-Lok Connector

Push pull
quick mating

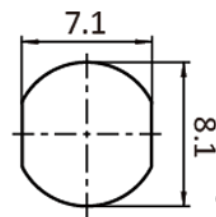

Circular Flange
(unit: mm)

Unrivaled InterConnects for Harsh Environments

About ALTW



3

Production Sites
(Taiwan, China, Mexico)



30+

Market Applications



90,000+

Products

Since 1993, Amphenol LTW Technology “ALTW” lives and breathes to create, innovate, design and produce “***unrivaled interconnects for harsh environments***”. With over 300 worldwide patents, not only does ALTW offer the broadest and widest range of rugged interconnects in the industry but also customization with the mission of “Customer Satisfaction First”. Undoubtedly, ALTW is the leader in rugged interconnects, highly recognized for its uncompromising quality, short lead time, fast and tailored service and its very competitive pricing.

Regardless of the challenging environments that your products will be subject to; there is a very good chance that you will find what you are looking for with ALTW.

HS-Lok Connector

Amphenol LTW's HS-Lok Push-Lock connectors provide you a simple quick and safe release to save you time and cost, with just a small pull force. HS-Lok offers IP68 waterproof protection and UL-F1 UV resistance, making them ideal for indoor or outdoor wet locations and space-constraint applications. In addition, the audible feedback and guided key design ensuring error-proof and easy assembly for blind mating.

Our HS-Lok connectors are UL2238 compliant and rated up to 5A for low voltage power and data transmissions, available in 2 to 6 contacts and hybrid (Power + Data) options to suit users variable requirements.

- ❖ Flammability UL 94V-0 & UV resistant
- ❖ UL2238 certified
- ❖ RoHS & REACH compliant



Panel Cut-Out

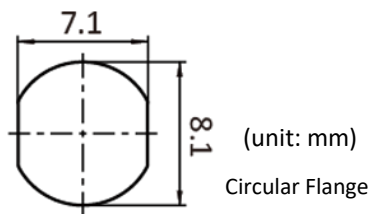

Accessory [\(click the image to find more product information\)](#)

Waterproof Cap

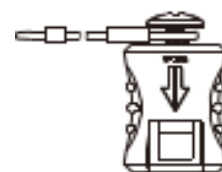

Size	Waterproof Cap	Mating Pair (Gender)	P/N
Q8	Cap only	FEMALE	CAP-WBBFQCA1
Q8	Cap only	MALE	CAP-WBBMQMA1
Q8	With fish line	MALE	CAP-WBBMQMD1

Product Range Overview

SUB SERIES	Q8
Mating Style	Push Pull
Plastic Version	✓
Metal Version	-
No. of Contacts	2 ~ 6
Plating of Contacts	Gold Plated
Operating Voltage (AC/DC)	100V DC, 300V, 300V AC / 100V DC
Nominal Current	2A, 5A, 5A+2A
Operating Temperature	Receptacle: -40°C ~ 105°C Overmolded With Cable: -40°C ~ 105°C Field Serviceable/Installable: -40°C ~ 105°C
Fasten Style of Nut	Front
Receptacle	✓
Receptacle with Cable	-
Field Serviceable/Installable	✓
Overmolded with Cable	✓
Accessories	✓
Mating Cycles (Pin Contact)	2000
IP Rating	IP68
Salt Spray (Connector, Mated)	500h
UV Resistant	✓
Flammability Rating	UL94V-0
Vibration Resistant	Frequency Range 10 ~ 55Hz / Amplitude 1.52mm
RoHS Compliant	✓
REACH Compliant	✓
Certifications	UL2238
Applicable Wire Gauge	24 ~ 20AWG

Served Markets & Applications

Market	Application	
LED Lighting	<ul style="list-style-type: none"> Architectural Lighting Residential, Medical, and Commercial Lighting Street, Parking lot, and Park Lighting Entertainment and Signage Lighting 	<ul style="list-style-type: none"> Horticulture, Grow, & Warehouse Lighting Mass Transportation and Vehicles Marine Vessel Lighting Appliances and Equipment Lighting
Marine	<ul style="list-style-type: none"> Navigation System: Radar, GPS, Sailing Instruments, Chart Plotter Communication: Radio, AIS Instrumentation & Monitoring: MFD, CCTV, Sensors 	<ul style="list-style-type: none"> Power Distribution: Appliances, Charging, HVAC Entertainment: Video, Audio, Decorative Motors: Outboard, Inboard, Pump, Actuator, Trolling
Broadband Wireless Access	<ul style="list-style-type: none"> Access Point: LTE, 5G Cellular, Subscriber, and Mobile Station Wireless Router and Mobile Backhaul 	<ul style="list-style-type: none"> Power Supply and Distribution System Other Communication Equipment
Industrial Automation	<ul style="list-style-type: none"> Motors: Servo, Step, Encoder, Actuator Power Supply and Distribution Robotic Arms, Packaging, and Conveyor System 	<ul style="list-style-type: none"> Controller: Machine Vision, AVI, Sensors Autonomous Robots, Forklifts Industrial PC, Counters, and Display
Renewable Energy	<ul style="list-style-type: none"> Energy Storage and Portable Energy 	
Heavy Equipment	<ul style="list-style-type: none"> Navigation System: GPS, Lidar, Radar, Ultrasonic Instrumentation, Control, and Diagnostic Systems Monitoring: Display, Camera, Imaging 	<ul style="list-style-type: none"> Safety System: Sensor, ADAS, Telematics & Tracking Communication and Electronic Toll Systems Power Distribution: Charging, Lighting, Equipment
Autometer	<ul style="list-style-type: none"> Metering: Water, Electric, & Gas Meter Power and Control: Drone, Security Alarm 	<ul style="list-style-type: none"> Monitoring: Sewage, Telemetry, and Vehicle Tracking
Test Equipment	<ul style="list-style-type: none"> Measuring Device: Air, Humidity, Light, Sound, Water, Image, Weight, Height Detectors: Gas, Fire, Leak, Motion, Heat Monitoring: Seismic (earthquake), Climatic 	<ul style="list-style-type: none"> Weighing: Weigh, In-motion Geodetic System: Surveying, Laser Marking, Borroscope
Hybrid Electric Vehicles	<ul style="list-style-type: none"> Motor Module: Scooter, Hoover board, Wheelchair Sensors: Speedometer, Fuel, Cleaning 	<ul style="list-style-type: none"> Device Communication: CAN, In-vehicle Info Lighting: Interior and Exterior LED
Railway Mass Transit	<ul style="list-style-type: none"> Navigation: GPS, Radar, Lidar, Ultrasonic HVAC Infotainment: Display, Sound, Broadcasting, Monitor 	<ul style="list-style-type: none"> Sensors: Speedometer, Fuel, Cleaning Communication: Main Controller, In-vehicle Info Lighting: Interior and Exterior
Mobile Devices	<ul style="list-style-type: none"> Drone Remote Controller Measurement: Altimeter, Gesture, Piezoelectric 	<ul style="list-style-type: none"> Handheld: Barcode, Scanner, Portable lamp, GPS
Transpo	<ul style="list-style-type: none"> Monitoring: Display, CCTV, Lidar, Surveillance Cam Navigation: GPS, Radar 	
Medical Equipment	<ul style="list-style-type: none"> Patient Care: Electric Beds, Wheelchair Lift & Stair, Rehabilitation System, Mobile Carts 	
Automotive Diagnostics	<ul style="list-style-type: none"> Auto-crash Detection & Notification System Vehicle Tracking and Roadside Assistance System 	<ul style="list-style-type: none"> Remote Diagnostics
UAV	<ul style="list-style-type: none"> Drone: Commercial, Consumer, & Military 	
Lifts & Materials Handling	<ul style="list-style-type: none"> Forklift, Industrial Lift, Material Handling 	
Remote Video Response Center	<ul style="list-style-type: none"> Monitoring: Display ,CCTV, Dome, IP Camera Detection: Auto-License Plate Recognition, Alarm Identification: Fingerprint, Face Detection, Encoders 	<ul style="list-style-type: none"> Remote Control Devices and Sensors Peripherals: Junction Boxes and Cabling System Lighting: Interior and Exterior
Autonomous	<ul style="list-style-type: none"> Navigation & Sensor: GPS, Lidar, Radar, Ultrasonic, IMU Imaging: Cameras, Monitors, Infotainment Display 	<ul style="list-style-type: none"> Controller: Inertial Measurement Unit & Navigation System, Central Computer
Rugged IT	<ul style="list-style-type: none"> Telemetry Military Notebook & Tablet and VR & AR 	<ul style="list-style-type: none"> Night Vision Goggles and Camera Communication Equipment



Amphenol LTW

Contact Us

Luc Kan | Sales & Marketing | luc@ltw-tech.com

Customer Service | sales@ltw-tech.com

Follow Us

